



Traffic Safety Corporation
2708 47th Ave.
Sacramento, CA 95822-3806
Toll Free: 888.446.9255
Tel: 916.394.9884
Fax: 916.394.2809
Email: sales@xwalk.com
Web: www.xwalk.com

Standard Traffic Signs MUTCD Compliant

We carry traffic signs in all shapes, sizes and styles. Many of our traffic signs are MUTCD and DOT compliant and feature reflective sheeting. All of our signs are made from rust free aluminum that won't chip or crack. An anti-graffiti protective overlay is available. Please contact us if you need a sign style that is not shown below.

Warning Signs

W1-1	W1-1a	W1-2	W1-2a	W1-3	W1-4	W1-5	W1-6	W1-7	W1-8
W1-10	W1-13	W1-15	W2-1	W2-2	W2-4	W2-5	W3-1	W3-2	W3-3
W3-3a	W4-1	W4-2	W4-3	W4-4p	W4-7	W5-1	W5-2	W5-3	W6-1
W6-2	W6-3	W7-1b	W7-2b	W7-3	W7-3a	W7-3b	W7-4	W7-4b	W8-1
W8-2	W8-3	W8-4	W8-5	W8-8	W9-1	W10-1	W10-1a	W10-2	W10-12
W11-1	W11-2	W11-3	W11-4	W11-5	W11-7	W12-1	W12-2	W12-2p	W13-1
W13-2	W13-3	W14-1	W14-2	W14-3	W15-1	W16-1	W16-2	W16-2a	W16-7p
W16-9p	S1-1	S3-1	S4-3	S4-5	S4-5a				

Visit our web site: www.xwalk.com



Traffic Safety Corporation
2708 47th Ave.
Sacramento, CA 95822-3806
Toll Free: 888.446.9255
Tel: 916.394.9884
Fax: 916.394.2809
Email: sales@xwalk.com
Web: www.xwalk.com

Standard Traffic Signs
MUTCD Compliant

Regulatory Signs

R1-1	R1-2	R1-2a	R1-4	R1-5a	R2-1	R3-1	R3-2		
R3-3	R3-4	R3-5	R3-5a	R3-6	R3-7	R3-8	R3-8a	R3-8b	
R3-9a	R3-10a	R3-11b	R3-14b	R3-18	R4-1	R4-3	R4-5	R4-6	
R4-7	R4-7a	R4-7b	R4-8	R4-10	R5-1	R5-1a	R5-2		
R5-6	R5-10a	R5-10c	R6-1	R6-2	R6-3	R6-3a	R7-8b	R7-9	R8-4
R8-8	R9-2	R9-3	R9-3a	R9-3b	R10-3	R10-4	R10-4b	R10-6	R10-7
R10-12	R10-15	R11-2	R12-1	R12-5	R14-1	R15-1	R15-2	S4-2	S5-2

Visit our web site: www.xwalk.com



Traffic Safety Corporation
2708 47th Ave.
Sacramento, CA 95822-3806
Toll Free: 888.446.9255
Tel: 916.394.9884
Fax: 916.394.2809
Email: sales@xwalk.com
Web: www.xwalk.com

Standard Traffic Signs
MUTCD Compliant

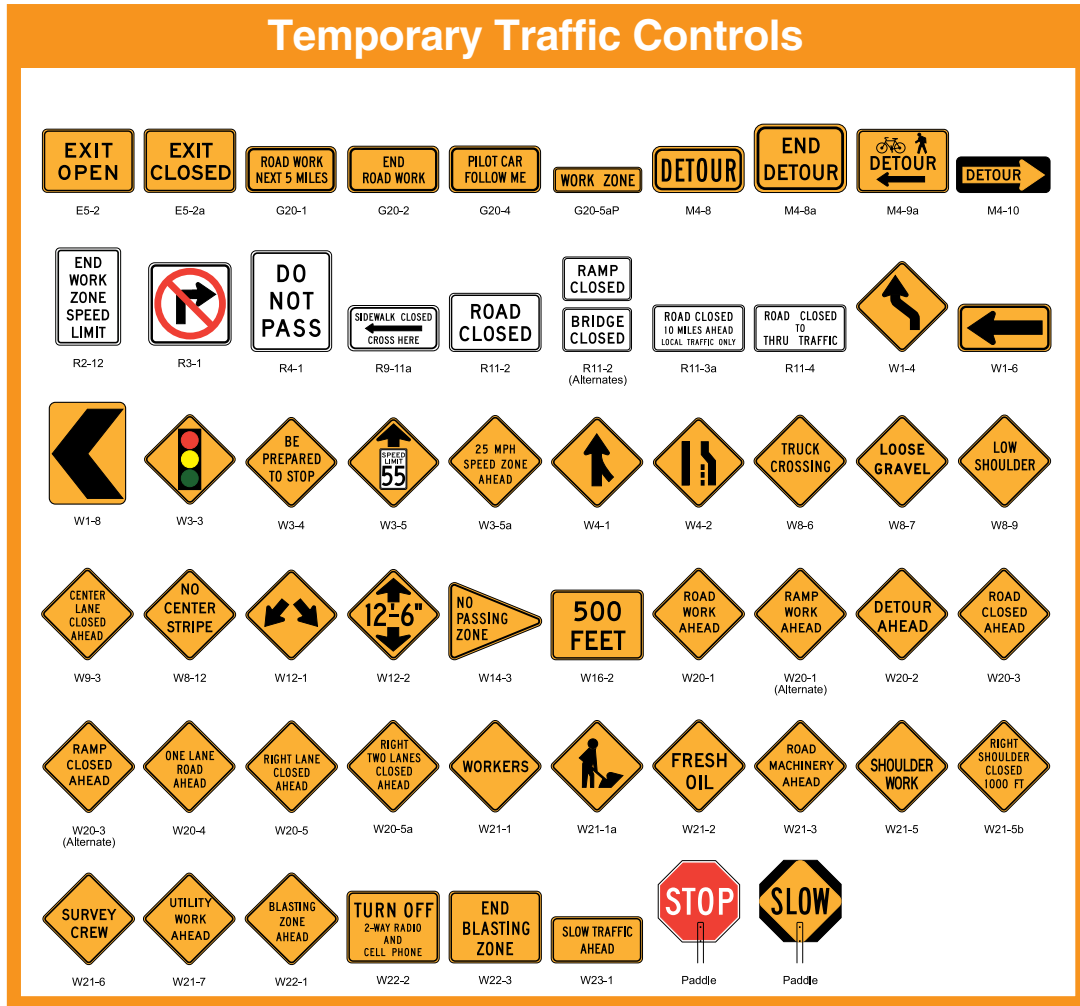

Visit our web site: www.xwalk.com



Traffic Safety Corporation
 2708 47th Ave.
 Sacramento, CA 95822-3806
 Toll Free: 888.446.9255
 Tel: 916.394.9884
 Fax: 916.394.2809
 Email: sales@xwalk.com
 Web: www.xwalk.com

Standard Traffic Signs
 MUTCD Compliant

Guide Signs

D Series (Destination Signs):

- D3-1: E MAIN ST
- D3-2: Johnson Blvd NEXT SIGNAL
- D4-1: PARKING
- D4-2: PARK & RIDE
- D5-1: REST AREA 1 MILE
- D5-2: REST AREA
- D7-1: YOSEMITE NAT'L PARK 1/4 MILE
- D8-1: WEIGH STATION 1 MILE
- D9-1: (Phone icon)
- D9-2: H
- D9-3a: (Bus icon)
- D9-6: (Wheelchair icon)
- D9-7: (Gas pump icon)
- D9-8: (Fork and knife icon)
- D9-9: (Bed icon)
- D9-11: (Gas pump with 'D' icon)
- D9-11a: (Gas pump with 'CNG' icon)
- D9-11b: (Gas pump with 'EV' icon)
- D9-13: (Star of life icon)
- D9-17: NEXT SERVICES 2.3 MILES

I Series (Interstate Signs):

- D11-1: BIKE ROUTE
- D12-1: WEATHER INFO TUNE RADIO TO 750 11230 96.3FM
- E9: Oakland NEXT 10 EXITS
- I-3: Brazos River
- I-5: (Airplane icon)
- I-7: (Train icon)
- I-12: (Bus icon)
- M1-1 Shield: INTERSTATE 5
- M1-6: LASSEN 16 COUNTY
- M1-7: 13 National Forest

M Series (Mileage Signs):

- M2-1: JCT
- M3-3: SOUTH
- M3-4: WEST
- M4-3: BUSINESS
- M4-5: TO
- M4-7: TEMPORARY
- M4-11: BEGIN
- M5-2: (Left turn arrow)
- M6-2: (Right turn arrow)
- M6-4: (Double arrow)
- M3-1: NORTH
- M3-2: EAST
- M4-1: ALTERNATE
- M4-4: TRUCK
- M4-6: END
- M4-12: END
- M5-1: (Left turn arrow)
- M6-1: (Right turn arrow)
- M6-3: (Up arrow)
- M6-6: (Right turn arrow)

R Series (Recreation Signs):

- RL-100: (Hiker icon)
- RM-010: (Mountain icon)
- RM-120: (Picnic table icon)
- RS-040: (Skier icon)
- RS-070: (Canoeist icon)
- RW-080: (Ski boat icon)
- RW-130: (Swimmer icon)
- Diagrammatic Sign: (North 270, East 495, Baltimore 2 MILES)

Note: These Federal M series signs may be used as white on green, white on blue, or black on white as appropriate.

Ordering Information

Sign #	Sign Size & Custom Information	Quantity

Custom Traffic Signs

Looking for a custom traffic sign? We can put your message on any sign. Please call for details.

Visit our web site: www.xwalk.com